

STROMAG™ DRUM BRAKES

WITH ELECTROHYDRAULIC THRUSTOR

SERVICE BRAKE FITTED WITH ELECTROHYDRAULIC THRUSTOR

Protected against adverse environmental effects in their respective applications, Series SDB have precisely tuned safety functions.

In hoisting and travelling drives, our SDB keep construction machinery safely in place and retain the rotary drives in required position, precisely.

The brake permits easy adjustment of the braking torque with a precise scale control. Our brake carries asbestos free lining pads and offers further additional options on demand.

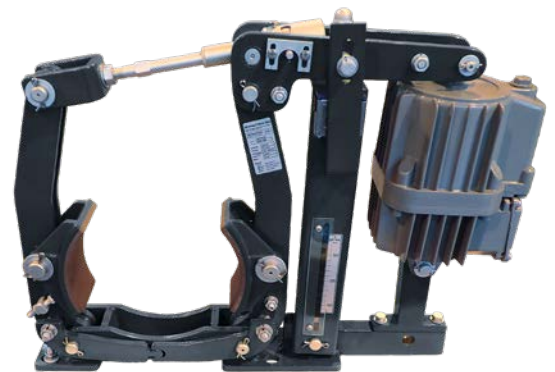

Benefits include

- Maintenance free, self lubricated bushes at main hinges and sliding joints
 - Brake shoe auto-aligning device and easy to change
 - Galvanized steel spindles and hinges
 - Automatic wear compensation
 - Glued lining pads and aluminium lightweight brake shoes according to DIN 15435
 - Optimised FEA tested design for reliability
 - These brakes are built as per DIN 15435 and Thrustors are built according to DIN 15430.
- The optional drums are built as per DIN 15431.

Applications

- Mining & Cement
- Hydro Power
- Oil & Gas
- Harbour & Shipping
- Steel
- Power



STROMAG™ DRUM BRAKES

TECHNICAL DATA/DIMENSIONS

Revision number: T10110-01-H Revision date: 18.10.2021

Standard DIN 15435

- Spring application braking
- Thrustor release
- Standard voltage 230/400 VAC 50Hz
- Protection level C4M
- Automatic lining wear compensation
- Brake shoe auto-aligning device
- Scale for torque adjustment
- Brake lever synchronization
- Aluminium shoes with non abestos organic linings
- Self lubricated bushings at main hinge points
- Galvanized steel spindles and hinges

Operating conditions

- Ambient temperature : -20°C to 50°C
- Relative humidity no higher than 90%
- IP rating: IP65

Options

HRL	Manual release lever
BRLS	Switch for opening monitoring
LWI	Full lining wear indicators
SS1	Special Switch: Schneider XCKM 110H29
SS2	Special Switch: Schmersal Z4VH335 11Z
AV-DV	Thrustor delay : Ascent or Descent Valve
SV	Special Voltage 415V 50Hz 500V 50Hz 480V 60Hz
SW	Steel Works (specific oil + heat resistant sealings)
SPA	Special paint according to the customer

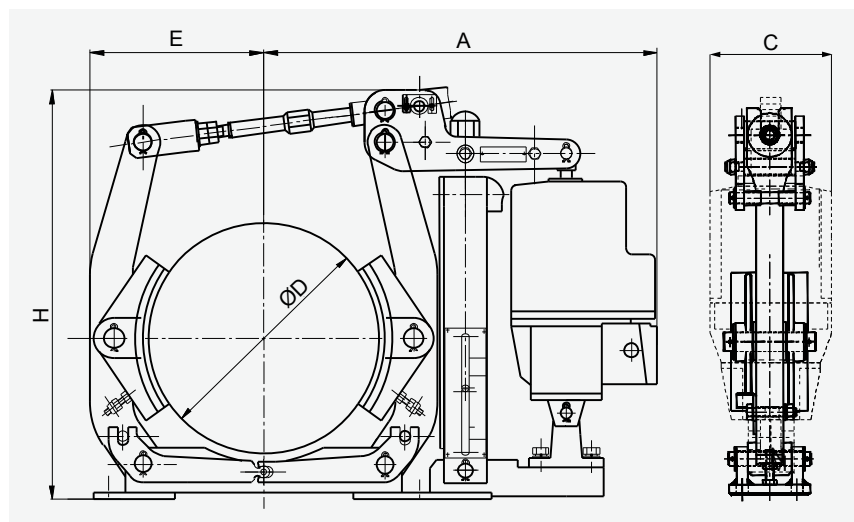

BRAKE TYPE	THRUSTOR	TORQUE (N.m.)		WEIGHT (kg)	DIMENSIONS (mm)				
		min.	max.		A	C	D	E	H
SDB 160	TS 230/5	80	160	28	428	160	160	140	418
SDB 200	TS 230/5	110	260	35	470	160	200	172	490
	TS 300/5	140	380	38					
SDB 250	TS 230/5	140	300	45	533	160	250	202	583
	TS 300/5	180	380	48					
	TS 500/6	300	600	53	570	195			
SDB 315	TS 230/5	180	340	70	670	160	315	253	585
	TS 300/5	250	500	70					
	TS 500/6	315	770	75		195			
	TS 800/6	630	1200	80					
SDB 400	TS 500/6	400	960	138	695	195	400	310	715
	TS 800/6	630	1500	140					
	TS 1210/6	1000	2400	155		240			775
SDB 500	TS 800/6	800	1920	176	925	240	500	380	803
	TS 1210/6	1250	3000	204					
	TS 2010/6	2000	4800	204					830
SDB 630	TS 1210/6	1800	3780	310	1150	240	630	465	1025
	TS 2010/6	2500	6000	310					
	TS 3010/6	4000	8500	315					
SDB 710	TS 2010/6	3150	6000	435	1180	240	710	520	1135
	TS 3010/6	5000	9600	441					



Regal Rexnord™

stromag.com

Stromag France SAS

Avenue de l'Europe

18150 La Guerche sur L'Aubois - France

+33 (0)1 49 90 32 20

regalrexnord.com

The proper selection and application of products and components, including assuring that the product is safe for its intended use, are the responsibility of the customer. To view our Application Considerations, please visit <https://www.regalrexnord.com/Application-Considerations>. To view our Standard Terms and Conditions of Sale, please visit <https://www.regalrexnord.com/Terms-and-Conditions-of-Sale>.

"Regal Rexnord" is not indicative of legal entity. Refer to product purchase documentation for the applicable legal entity.

Regal Rexnord and Stromag are trademarks of Regal Rexnord Corporation or one of its affiliated companies.

© 2021, 2024 Regal Rexnord Corporation, All Rights Reserved. MCF-P-8228-SG-EN-A4 09/24

