

Self-Contained Freewheels

FS 750-1027, FSO 750-1027, HPI 750-1027



TYPE



FSO

Types FS, FSO, and HPI 750 to 1027 are sprag type freewheels self-contained, sealed and bearing supported.

Units are delivered oil or grease lubricated according to the type. It is a Formsprag USA design that uses sprags specially designed to compensate for any eccentricity due to bearing wear. Types FS and HPI are oil lubricated and use standard shaft lip seals. Type FSO is grease lubricated and equipped with special grease seals, labyrinth seals can also be selected on request.

Type HPI is specially designed for high speed indexing applications. Each of the different models show a range of standard metric bore diameters. We can supply any bore size between the minimum and maximum specified in the table, including imperial sizes.

Self-Contained Freewheels

FS, FSO, HPI 750-1027

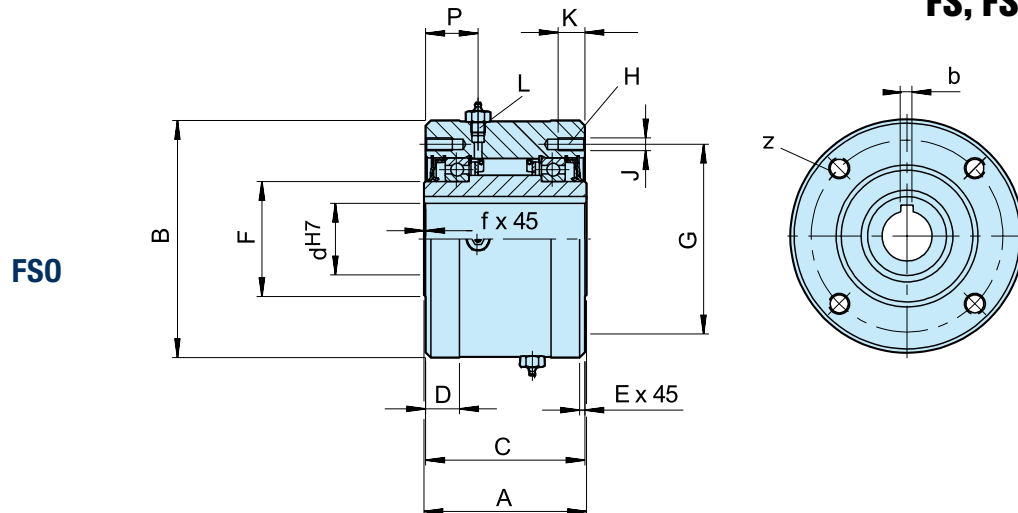

| Type | Size | | Overrunning speeds | | | | | | | | | | | | Number | | | | | | | | | | Lubricant | | | Weight | Drag torque |
|------------------|------|---------------------------------------|--------------------------------------------------------|--------------------------------------------------------|----------------------|-----------------|-------|-----------------|-------|------|-----|--------|--------|----|--------|----|--------|------|-----|-----|-----|-----|-----|----------------|-----------|--|--|--------|-------------|
| FSO FS HPI | | | FS / FSO** / HPI Lip Seal | FSO Labyrinth Seal | d ^{H7} -bxh | d ⁴⁾ | A | B ⁵⁾ | C | D | E | F | G | z | J | K | L | P | f | FSO | HPI | FS | | T _R | | | | | |
| | | T _{KN} ¹⁾ [Nm] | n _{max} ²⁾ [min ⁻¹] | n _{max} ³⁾ [min ⁻¹] | | min-max [mm] | | -0,05 [mm] | | | | | | | | | | | | | | | | | | | | | |
| | 750 | 9520 | 1000/650 | 1800/650 | 65-18x11 | 57–87 | 152,4 | 222,25 | 149,2 | 31,7 | 1,6 | 107,74 | 177,8 | 8* | M12* | 25 | 1/2-20 | 49,2 | 1,6 | 222 | 384 | 207 | 38 | 5,08 | | | | | |
| | | | | | 70-20x12 | | | | | | | | | | | | | | | | | | | | | | | | |
| | | | | | 75-20x12 | | | | | | | | | | | | | | | | | | | | | | | | |
| | | | | | 80-22x14 | | | | | | | | | | | | | | | | | | | | | | | | |
| | | | | | 85-22x14 | | | | | | | | | | | | | | | | | | | | | | | | |
| | 800 | 17680 | 850/525 | 1500/525 | 80-22x14 | 66–112 | 152,4 | 254,00 | 149,2 | 31,7 | 1,6 | 139,70 | 227,0 | 8 | M12 | 25 | 1/2-20 | 49,2 | 1,6 | 222 | 444 | 251 | 46 | 7,12 | | | | | |
| | | | | | 90-25x14 | | | | | | | | | | | | | | | | | | | | | | | | |
| | | | | | 100-28x16 | | | | | | | | | | | | | | | | | | | | | | | | |
| | | | | | 110-28x16 | | | | | | | | | | | | | | | | | | | | | | | | |
| | 900 | 24480 | 700/500 | 1350/500 | 100-28x16 | 92–138 | 161,9 | 304,80 | 158,7 | 34,9 | 1,6 | 161,92 | 247,65 | 10 | M16 | 32 | 1/2-20 | 54 | 1,6 | 532 | 473 | 340 | 71 | 8,47 | | | | | |
| | | | | | 110-28x16 | | | | | | | | | | | | | | | | | | | | | | | | |
| | | | | | 120-32x18 | | | | | | | | | | | | | | | | | | | | | | | | |
| | | | | | 130-32x18 | | | | | | | | | | | | | | | | | | | | | | | | |
| | 1027 | 36720 | 500/375 | 700/375 | 130-32x18 | 125-177 | 168 | 381,00 | 165,1 | 34,9 | 3,2 | 228,60 | 298,45 | 12 | M16 | 32 | 1/2-20 | 54 | 3,2 | 651 | 946 | 473 | 113 | 13,56 | | | | | |
| | | | | 150-36x20 | | | | | | | | | | | | | | | | | | | | | | | | | |
| | | | | 175-45x25 | | | | | | | | | | | | | | | | | | | | | | | | | |

NOTES

- 1) $T_{\max} = 1.5 \times T_{KN}$
» Refer to Selection page 7 to 11
- 2) Inner race/outer race
- 3) Inner race/outer race
- 4) Inch bore available on request
- *) 6 holes equally spaced at 60° plus
2 extra-holes at 180°
- 5) Tolerance for sizes 900 and 1027: -0,08
- **) FSO 750 are always supplied with labyrinth seal

MOUNTING EXAMPLE

